



The Colden Common Shed

Southern Network Forum

8th April 2019

History – The Start

- Spring 2015 – Initiation meeting in Recreation Pavilion; over 30 attendees
- Started refurbishment of attached tractor garage as workshop
- 23/7/2015 – Inaugural AGM; agreed constitution, elected Trustees
- Completed refurbishment; painted, new wiring, insulation, ceiling, workbenches, etc
- Applied for and were granted CIO status in July 2016; revised constitution accordingly



History - Next Steps

- As the Recreation Pavilion was an interim venue:
 - approached the COE School Trust to lease land for a new shed
 - agreed heads of agreement in May 2017
 - lease drawn up and signed December 2017
 - registered with Land registry in October 2018
- Discussed options for new shed with Building Control during 2016:
 - advised to build 3 sheds < 30m²
 - designed a 2 shed layout, but quotes too high (£65k before services & fitout)



History – The Build

- Decided on flatpack log cabins and obtained planning permission in Feb 2018
 - designed 110 m² supporting platform
- Applied for and obtained grants from various bodies between Jan and April 2018
- Commenced building supporting platform in April 2018
- Completed the social shed fit-out in February
- Workshop fit-out in progress
- Store shed fit-out to commence imminently



Log Cabin Platform Design

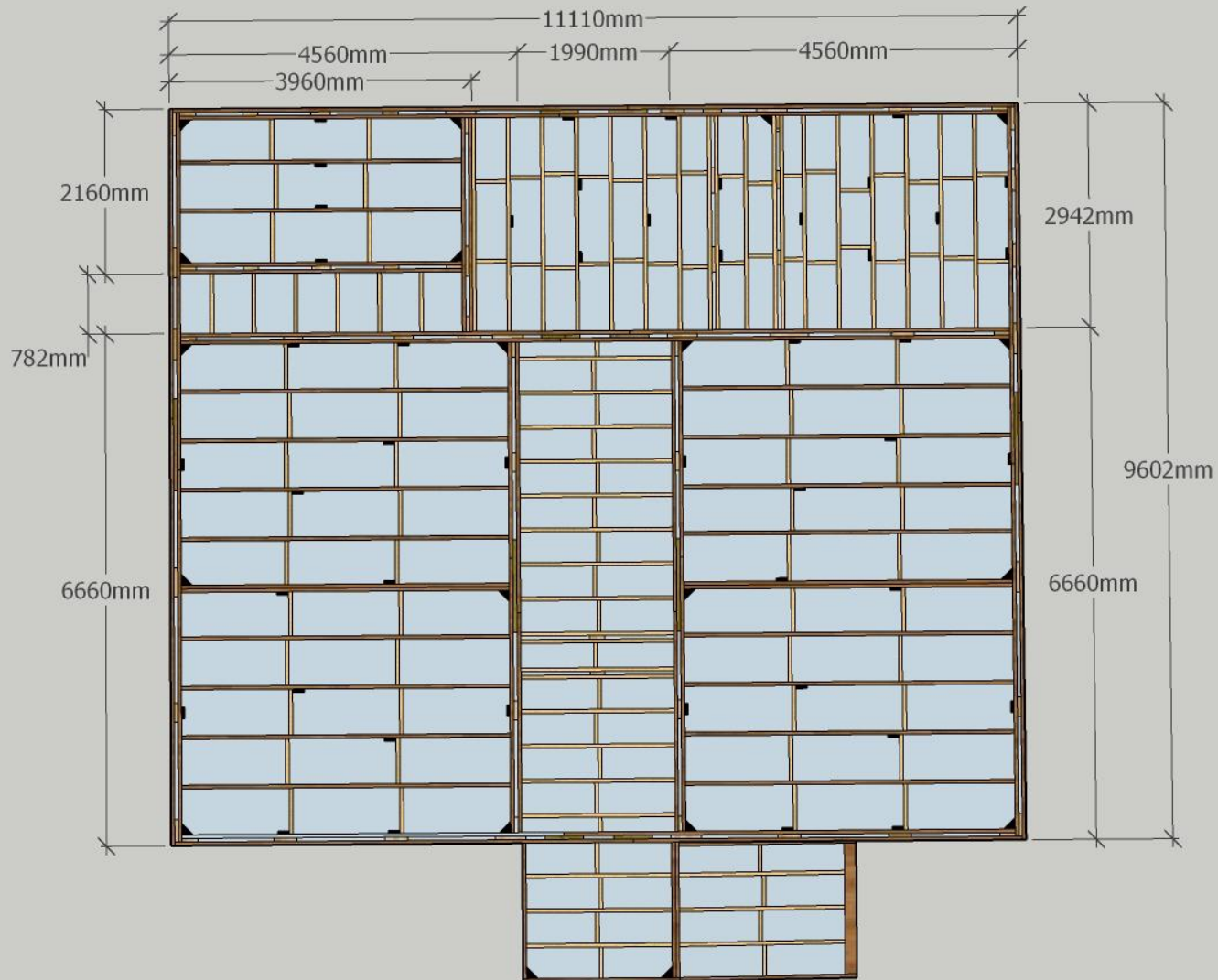

The Build in Progress







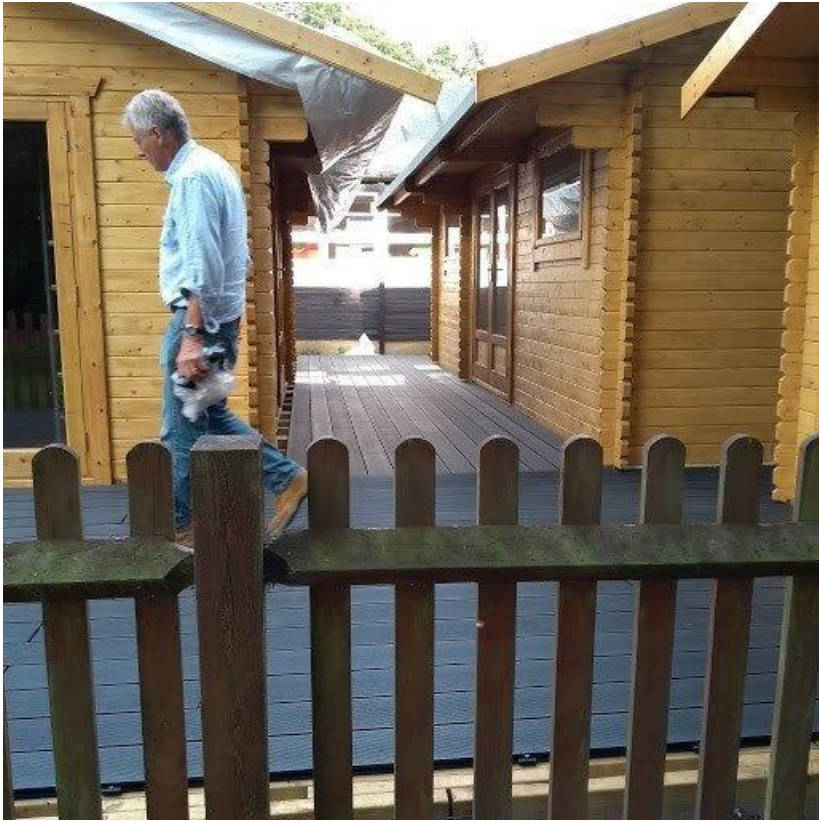



Applications for Funding

Colden Common Parish Hall Trust

Taylor Wimpey

Hampshire County Council

Colden Common Parish Council

Winchester City Council - Winnovation

The Big Lottery

Peoples Post Code Community Trust

Chapman Charitable Trust

The Bassil Shippam and Alsford Trust

The Rowan Benthall Charitable Trust

The Richard Kirkman Trust

Allen Lane Foundation

Garfield Weston Foundation

Aviva Community Fund

Fieldfare - Leader Funding

ASDA Foundation

Barker Hill Memorial Foundation

The Colifax Charitable Trust

The Alice Ellen Couper Dean Charitable trust

BIFFA (Wildlifetrusts)

RVS ASDA Sheds Fund

Hobson Trust

Barclays Bank

Winchester City Council -Small Project Grant Fund

Local Giving - The Southern Co-op

The Shanly Foundation

Zurich Community Trust

Cala Homes Community Bursary

Comic Relief - Tech for Good 2018

England - Reaching Communities

Rural Community Buildings Loan Fund

Wakeham Trust

Dunhill Medical Trust

Peoples Health Trust (Health Lottery)

Comic Relief Core Strength - Local Communities Programme



Project Supporters

- The Post Code Community Trust
- The Big Lottery Fund
- Colden Common Parish Hall Trust
- Winchester City Council
- Colden Common Parish Council
- Taylor Wimpey
- Hampshire County Councillor